

CITY OF SMITHS GROVE

POST OFFICE BOX 114

SMITHS GROVE, KENTUCKY 42171

112.3 79-6 ANNEXATION ORDINANCE

BE IT ORDAINED BY THE BOARD OF TRUSTEES OF THE CITY OF SMITHS GROVE:

SECTION I: That the corporate limits of the City of Smiths Grove, Kentucky, as now established, be extended so as to embrace the territory hereinafter accurately described, and to annex the territory hereinafter described to the said City of Smiths Grove, Kentucky, viz:

"Beginning at a concrete right of way marker 45 feet east of the center line of Ky. Hwy. #101 and being a corner to the Leon Tarter property, then with the highway right of way as follows, S. $32^{\circ}16'$ W. 358.07' to a corner 45' East of the center line of Ky. Hwy. #101, thence with the highway right of way S. $34^{\circ}31'$ W. 190.24 ft. to a corner 30 ft. east of the center line of Ky. Hwy #101, said corner being a corner to the Richard Kirby property then with the Kirby line S. $76^{\circ}56'$, 387.88 ft. to a corner post, corner to Fay Martin and Geneva Anderson, then with the Anderson line N. $2^{\circ}50'$ e, 610.14 ft. to a corner stone, corner to Benton Anderson and Leon Tarter then with the Tarter line S $62^{\circ}19'$, W 121.59 ft. to the beginning corner." The afore described tract containing 3.01 acres.

SECTION II: That this ordinance shall be in full force and effect from and after its adoption, approval, and publication, and all ordinances or parts of ordinances in conflict herewith are repealed and held for naught.

ADOPTED : April 8, 1979

APPROVED: Carolyn B. Haslin
Chairman, Board of Trustees

ATTEST: Joe M. Edwards
City Clerk

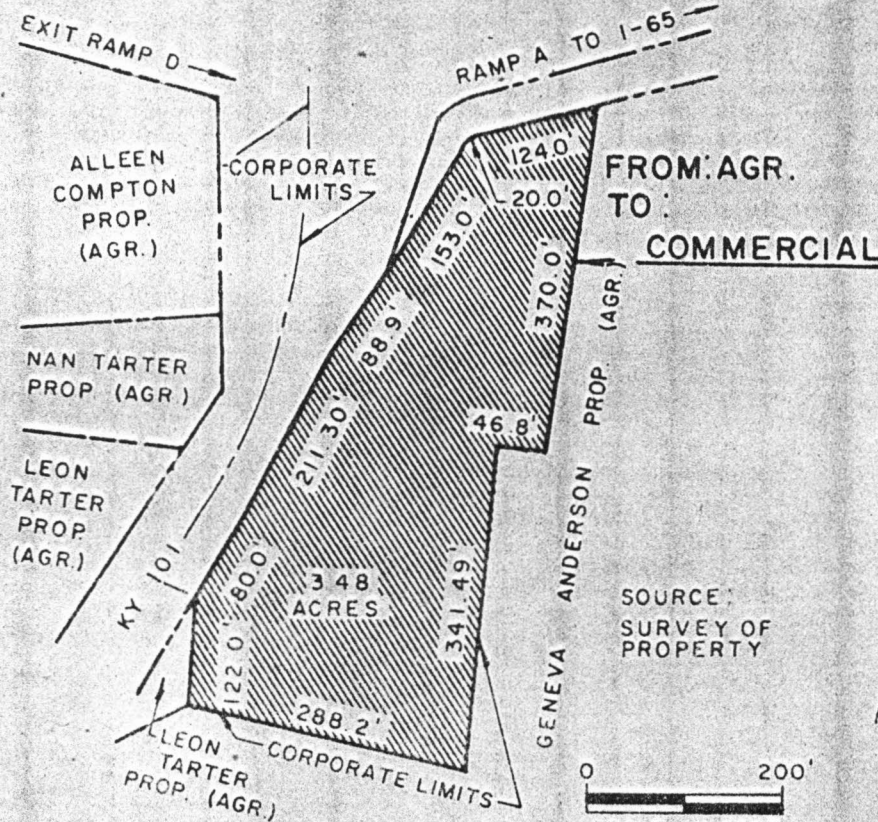

SOURCE:
SURVEY OF
PROPERTY

DRAWN BY JERRY WOODCOCK